



East Street
Thame

White Lion
Residential

East Street

Thame OX9 3JS



- Two Double Bedroom Period Home
- Downstairs WC & Wetroom
- Upstairs Three Piece Bathroom
- Council Tax Band C / Freehold
- Open Plan Sitting/Dining Room with Wood Burner
- Modern Double Glazed Sash Windows
- Garden Building with Light & Power
- Central Thame Location

About the property

A beautifully presented two double bedroom character cottage located close to the centre of town. The home comprises of a 24ft open plan sitting/dining room with wood flooring and a wood burner. To the rear of the property is a full width kitchen and a downstairs wetroom with shower and WC. Upstairs are two double bedrooms and a three-piece family bathroom. To the rear of the property is a pleasant garden with decked seating areas. To the rear of the garden is the garden building which is of timber construction with power and light. This would make an ideal space in which to work.





About the area

Thame is a bustling market town surrounded by beautiful countryside with many walks, including the Phoenix Trail. Thame spreads out from the historic market place and there are numerous high quality independent shops including butchers, bakers and delicatessens, in addition to Waitrose and the usual chains. There are weekly markets and other amenities include: the sports centre, Lord Williams Secondary School and a variety of restaurants and pubs. Haddenham Parkway Station is less than three miles from the town centre and the M40 is under 10 minutes' drive.



*"A Beautifully Presented Character Home
Located Close to the Town Centre"*



Money Laundering Regulations - Intending purchasers will be asked to produce identification documentation at a later stage and we would ask for your co-operation in order that there will be no delay in agreeing the sale. 1: These particulars do not constitute part or all of an offer or contract. 2: The measurements indicated are supplied for guidance only and as such must be considered incorrect. 3: Potential buyers are advised to recheck the measurements before committing to any expense. 4: White Lion Residential has not tested any apparatus, equipment, fixtures, fittings or services and it is the buyers interests to check the working condition of any appliances. 5: White Lion Residential has not sought to verify the legal title of the property and the buyers must obtain verification from their solicitor. W810

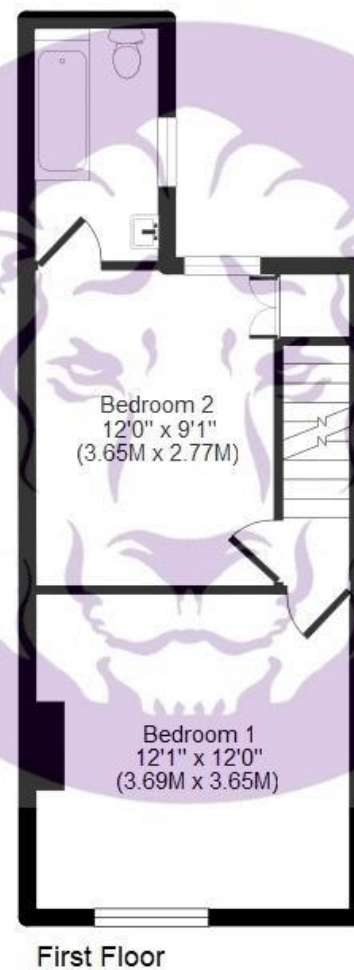
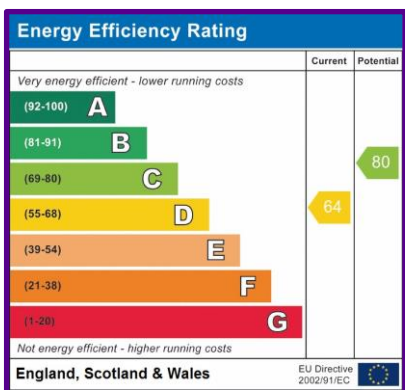

East Street, Thame, Oxfordshire, OX9 3JS
 APPROX GROSS INTERNAL FLOOR AREA: 80.32 sq. m / 864.26 sq. ft

The Old Stores, High Street, Tetsworth, Thame, Oxfordshire OX9 7AS
 t. 01844 280000 e. info@whitelionresidential.co.uk

